

# COUNTY OF TILLAMOOK

OFFICE OF  
COUNTY ENGINEER

TILLAMOOK, OREGON,

March 28, 25

Surveyor General for Oregon

Dear Sir:

In surveying the boundaries of Sec. 6, T3S. R9W. WM. it has been found necessary to re-establish the  $\frac{1}{4}$  cor on the North line of the section, and in doing this my deputy followed the instructions given in the I.C.S. Reference Library and relating to sec. 6 only.

"For example, suppose that it is stated in the field notes that the closing corner on the township line for the section line bet Sections 5 and 6 is 135 links East of the Standard corner for Sections 31 and 32 of the township north of the township line, but by actual measurement the distance is found to be 185 links. In this case the  $\frac{1}{4}$  section corner for Section 6 is placed on the township line at the same distance; namely 185 links, actual measure East of the standard  $\frac{1}{4}$  section corner for Section 31 of the township north of the line. This is illustrated in Fig. 5, which shows the method of locating the north  $\frac{1}{4}$  post of Section 6.

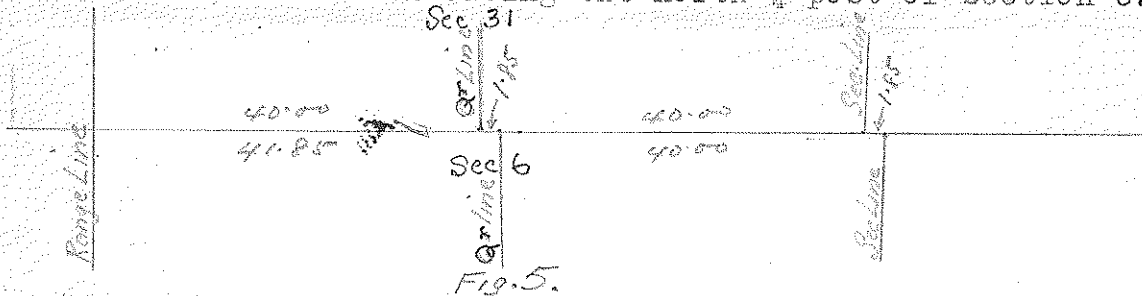

We do not seem to find anything in your pamphlet on "Restoration of Lost or Obliterated Corners" to verify this method, and as there is quite a dispute over the line, based on local knowledge of where the corner used to stand, which however is not well enough defined to set the corner from, We would like to be advised of the correct method of re-establishing this corner, as we had used the above described method in good faith, and in this one instance only

yours truly

*W. S. Coates*